

Pull Studs RK BT-MAS-403

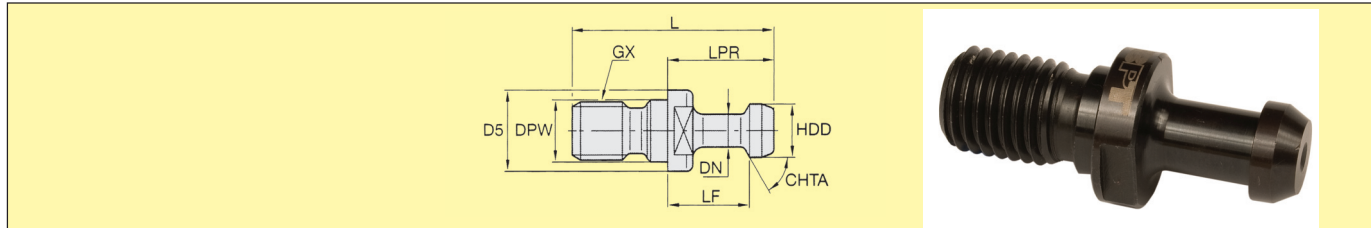

- Pull Studs BT MAS Style With Pilot – Metric`
Metric Threads, Piloted, No Through Coolant
- Order Example – RK30BT1M
Through coolant pull studs available upon request
- Order Example – RK30BT1MC

- Pull Studs BT MAS Style With Pilot – Inch
Threads, Piloted, No Through Coolant
- Order Example – RK31114
Through coolant pull studs available upon request
- Order Example – RK31114C

Pull Studs RK BT-MAS-403-METRIC

Catalogue No.	Taper Size	GX	CHTA in Deg.	D5	DN	DPW	HDD	LF	LPR	L	WF
RK30BT1M	30	M12~1.75	45	16.40	6.95	12.49	10.95	17.95	22.95	43	13
RK30BT2M	30	M12~1.75	60	16.40	6.95	12.49	10.95	17.95	22.95	43	13
RK40BT1M	40	M16~2.00	45	22.90	9.95	16.99	14.95	27.95	34.95	60	19
RK40BT2M	40	M16~2.00	60	22.90	9.95	16.99	14.95	27.95	34.95	60	19
RK40BT3M	40	M16~2.00	90	22.90	9.95	16.99	14.95	27.95	34.95	60	19
RK50BT1M	50	M24~3.00	45	37.90	16.95	24.99	22.95	34.95	44.95	85	30
RK50BT2M	50	M24~3.00	60	37.90	16.95	24.99	22.95	34.95	44.95	85	30
RK50BT3M	50	M24~3.00	90	37.90	16.95	24.99	22.95	34.95	44.95	85	30

Pull Studs RK BT-MAS-403-INCH

Catalogue No.	Taper Size	GX	CHTA in Deg.	D5	DN	DPW	HDD	LF	LPR	L	WF
RK31114	40	5/8"~11	45	0.938"	0.392"	0.636"	0.589"	0.988"	1.264"	2.250"	0.750"
RK31114B	40	5/8"~11	90	0.938"	0.392"	0.636"	0.589"	0.988"	1.264"	2.250"	0.750"
RK31118	50	1.00"~8	45	1.438"	0.668"	1.026"	0.903"	1.384"	1.778"	3.355"	1.250"
RK31118B	50	1.00"~8	90	1.438"	0.668"	1.026"	0.903"	1.384"	1.778"	3.355"	1.250"

Pull Studs ANSI-Style with out Pilot - INCH

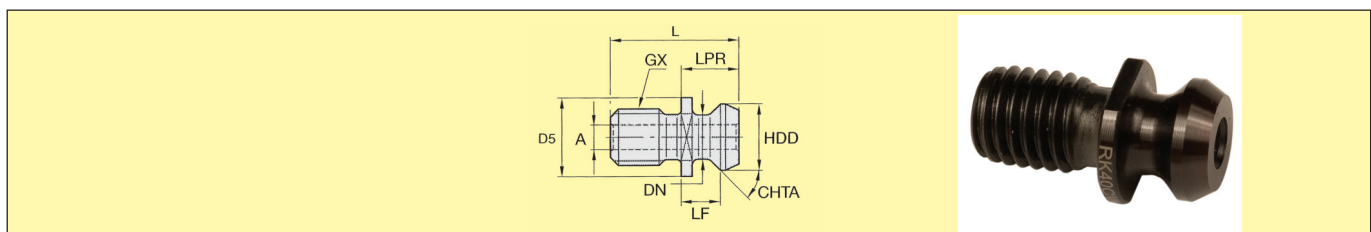

- Pull Stud-ANSI Style without pilot
Inch Thread, Through Coolant
- Order Example – RK40CV

Catalogue No.	Taper Size	GX	CHTA	D5 in Deg.	DN	HDD	LF	LPR	L	WF	A
RK40CV	40	5/8"~11	45	0.900"	0.490"	0.740"	0.440"	0.640"	1.500"	0.750"	0.281"
RK50CV	50	1.00"~8	45	1.400"	0.820"	1.140"	0.700"	1.000"	2.300"	1.250"	0.500"